

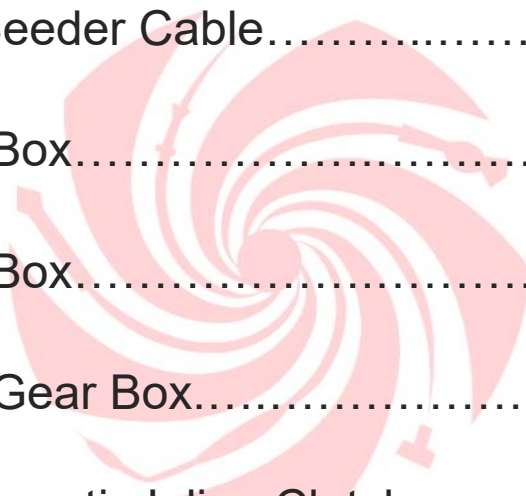

SEEDER DRIVE

INDEX



I. Flexible Seeder Cable.....	01
II. 2:1 Gear Box.....	03
III. 3:1 Gear Box.....	05
IV. EX Drive Gear Box.....	07
V. Electromagnetic Inline Clutch.....	09



Flexible Seeder Cable Technical Specification:

Sl. No.	Parameter	Parameter Value
1	Transmission Ratio	1:1
2	Gear Box End Mating Dimension	Refer Page 2
3	Clutch End Mating Dimension	Refer Page 2
4	Output torque (nominal/peak)	8 N-m (input) / 14 N-m (peak)
5	Torque Overload (up to failure)	Clockwise 30 N-m Anti-clockwise 21 N-m
6	Corrosion Resistance	48 hrs against white rust; 96 hrs against red rust
7	Endurance	Tested up to 1000 Hours
8	Tensile Pull Out Load (End fittings)	Can withstand up to 500 N/ 50 kgf

Fitment Dimensions:

The flexible cable can be manufactured for varying lengths and combination of end fittings based on the customer requirement and the type of gearbox used.

The seeder cable has two variants based on the end application:

<u>Version</u>	<u>Description</u>
Type 1	Non-clutch Version Seeder Cable
Type 2	Clutch Version Seeder Cable

Regular Version

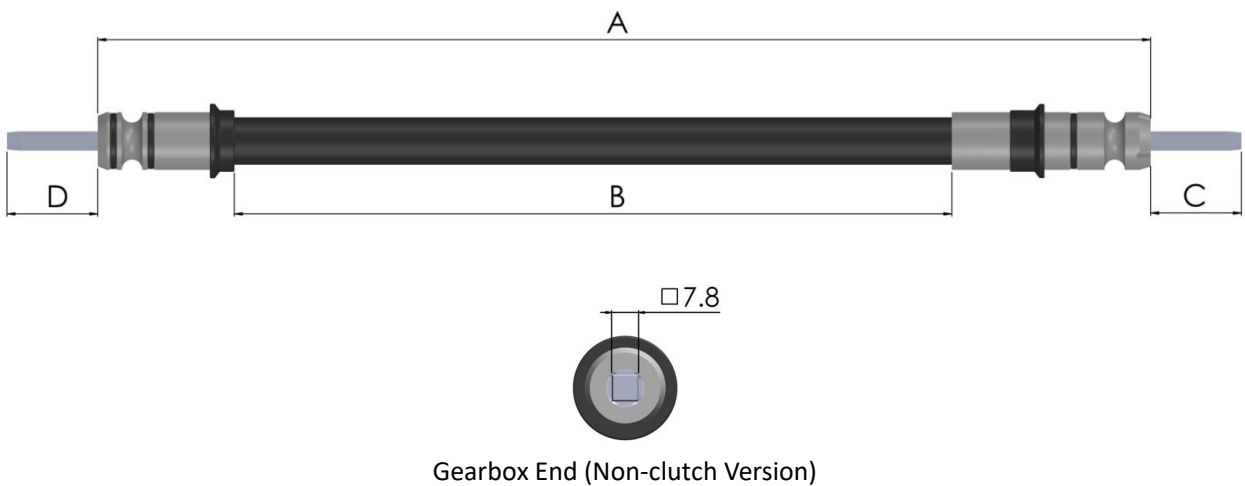

Clutch Version

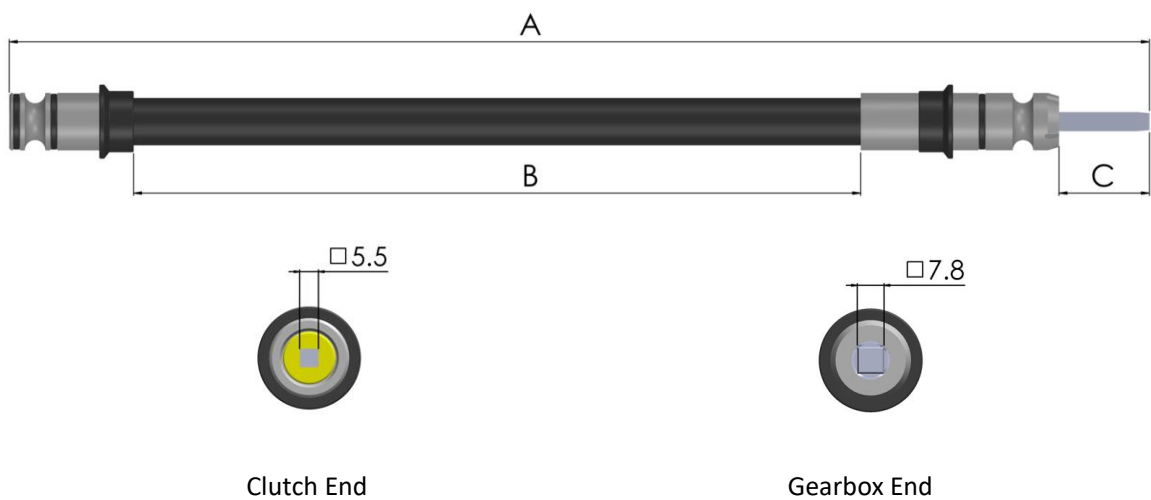

Note: The lengths 'A', 'B', 'C' and 'D' can be varied based on customer requirement
All dimensions are in "mm"

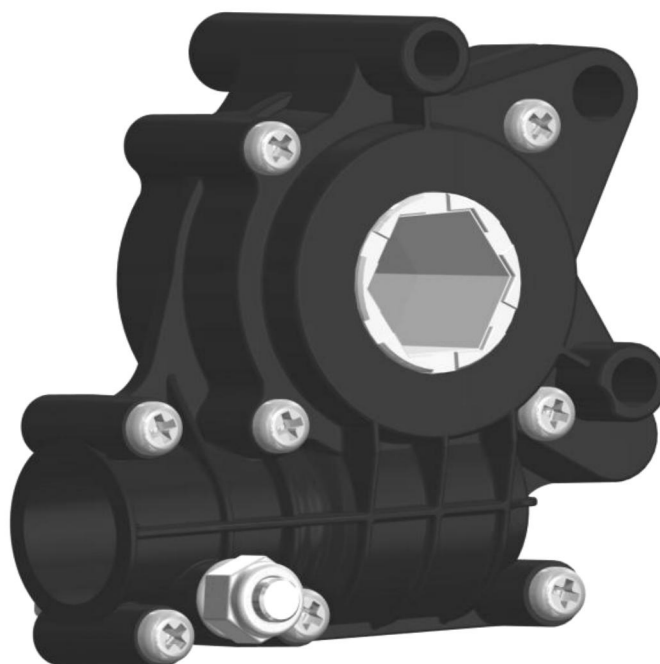

2:1 Gear Box Technical Specification:

<i>Sl. No.</i>	<i>Parameter</i>	<i>Parameter Value</i>
1	Gear Ratio	2:1
2	Input Mating Dimension	Hexagonal shaft; Refer Page 4
3	Operational torque (input/peak)	8 N-m (input) / 12 N-m (peak)
4	Output torque (nominal/peak)	4 N-m (input) / 6 N-m (peak)
5	Output Mating Dimension	Flexible core; Refer Page 4
6	Corrosion Resistance	72 hrs against white rust; 144 hrs against red rust
7	UV Protection	600+ Hours
8	Endurance	Tested up to 1000 Hours

Fitment Dimensions:

The 2:1 Gear box comes in three variants:

<u>Part Number</u>	<u>Description</u>
OGB-03	2:1 Short Version
OGB-01	2:1 Long Version- Type 1
AGB-01	2:1 Long Version- Type 2

2:1 Short Version

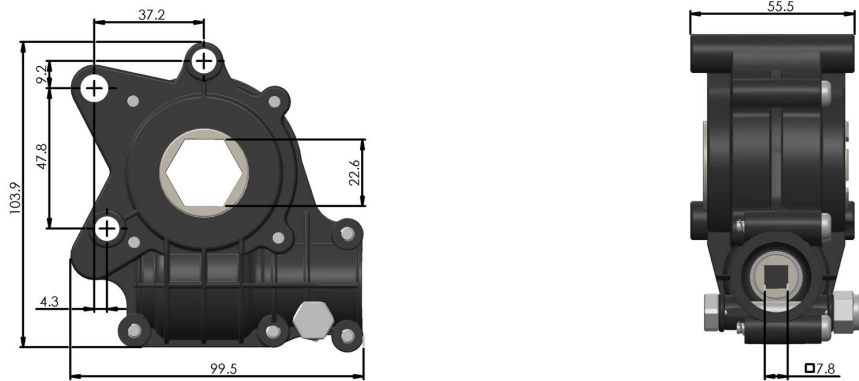

2:1 Long Version- Type 1

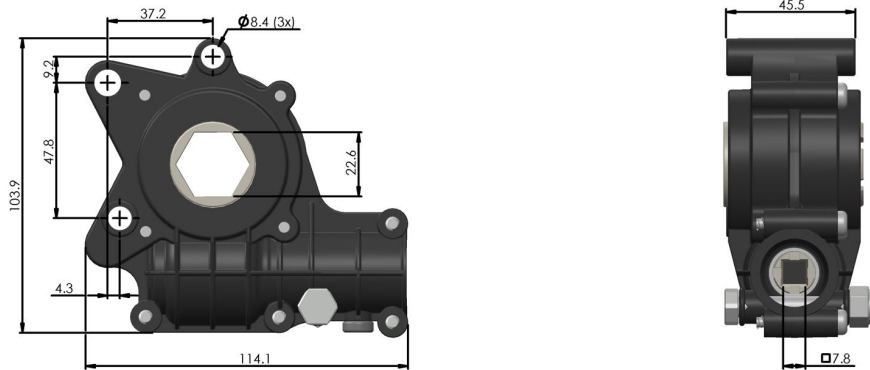

2:1 Long Version- Type 2

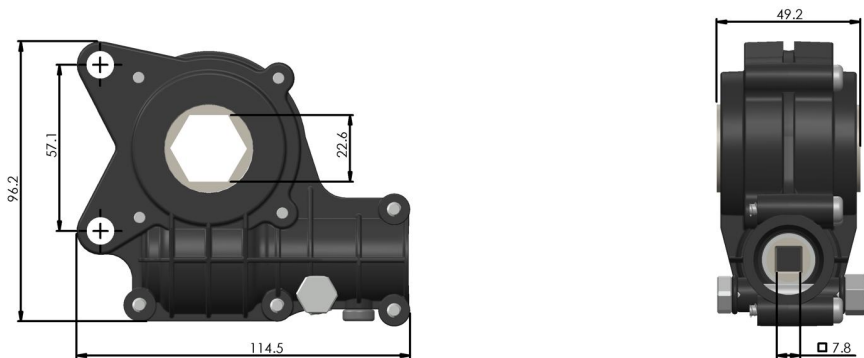

Note: All dimensions are in "mm"



3:1 Gear Box Technical Specification:

<i>Sl. No.</i>	<i>Parameter</i>	<i>Parameter Value</i>
1	Gear Ratio	3:1
2	Input Mating Dimension	Hexagonal shaft; Refer Page 6
3	Operational torque (input/peak)	8 N-m (input) / 12 N-m (peak)
4	Output torque (nominal/peak)	2.67 N-m (input) / 4 N-m (peak)
5	Output Mating Dimension	Flexible core; Refer Page 6
6	Corrosion Resistance	72 hrs against white rust; 144 hrs against red rust
7	UV Protection	600+ Hours
8	Endurance	Tested up to 1000 Hours

Fitment Dimensions:

<u>Part Number</u>	<u>Description</u>
AGB-03	3:1 Gear Box

3:1 Gear Box

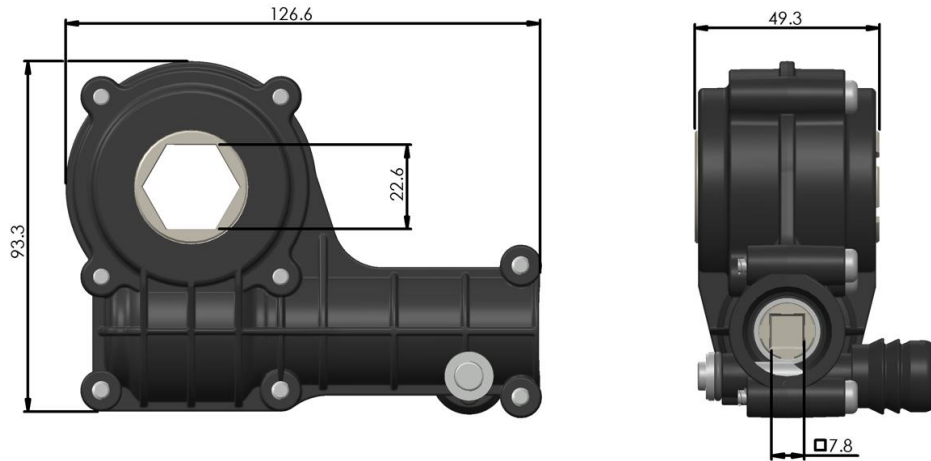

Note: All dimensions are in "mm"

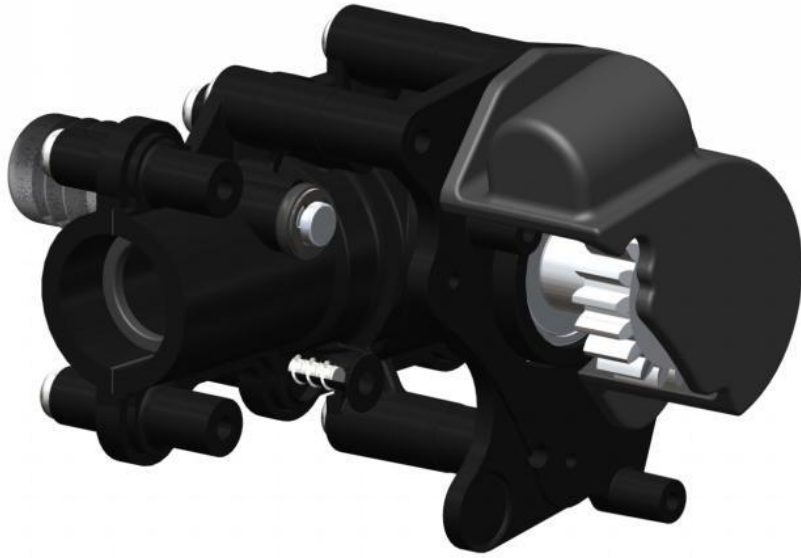

EX Drive Gear Box Technical Specification:

<i>Sl. No.</i>	<i>Parameter</i>	<i>Parameter Value</i>
1	Gear Ratio	2:1
2	Input Mating Dimension	Flexible core; Refer Page 8
3	Operational torque (input/peak)	4 N-m (input) / 6 N-m (peak)
4	Output torque (nominal/peak)	2 N-m (input) / 3 N-m (peak)
5	Gear Box Output Mating	Spur Gear
6	Corrosion Resistance	72 hrs against white rust; 144 hrs against red rust
7	UV Protection	600+ Hours
8	Endurance	Tested up to 1000 Hours

Fitment Dimensions:

The EX Drive Gear box comes in two variants:

<u>Part Number</u>	<u>Description</u>
OGB-02	EX Drive- Type 1
OGB-04	EX Drive- Type 2

EX Drive- Type 1

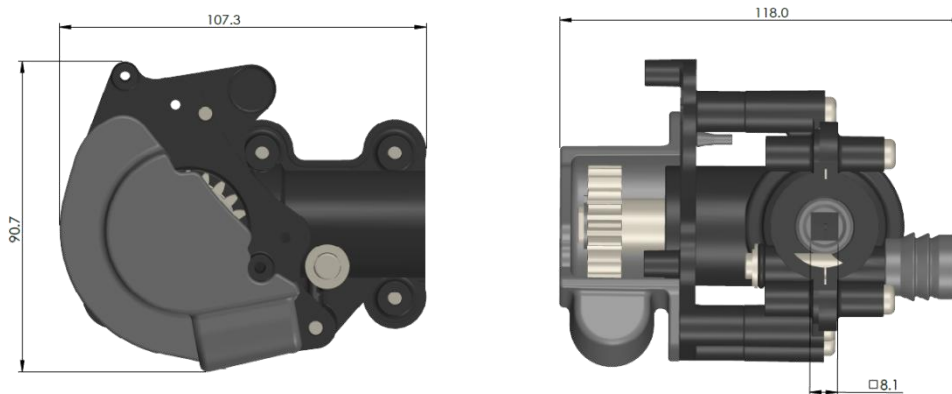

EX Drive- Type 2

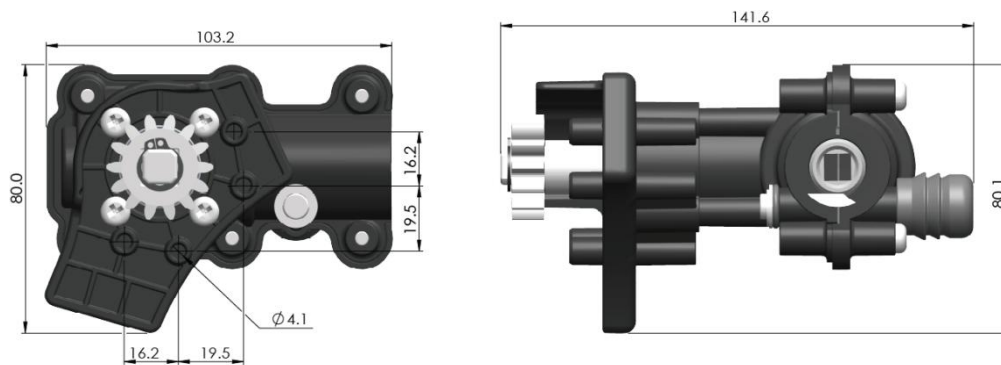

Note: All dimensions are in "mm"



Electromagnetic Inline Clutch Technical Specification:

<i>Sl. No.</i>	<i>Parameter</i>	<i>Parameter Value</i>
1	Transmission Ratio	1:1
2	Input Shaft Dimensions	Refer Page 10
3	Operational torque (input/peak)	4 N-m (input) / 6 N-m (peak)
4	Output torque (nominal/peak)	4 N-m (input) / 6 N-m (peak)
2	Output Shaft Dimensions	Refer Page 10
6	Voltage vs Current Drawn	12 V DC Supply; 0.3 A Current Drawn
7	Ingress Protection	IP55
8	Clutch Type	OFF Type Clutch (Transmits Torque in POWER-OFF condition)
9	Connector Type	Inbuilt 2-pin Male Connector
10	Corrosion Resistance	72 hrs against white rust; 144 hrs against red rust
11	UV Protection	600+ Hours
12	Endurance	Tested up to 1000 Hours

Fitment Dimensions:

<u>Part Number</u>	<u>Description</u>
EMC-01	Electromagnetic Inline Clutch

Electromagnetic Inline Clutch

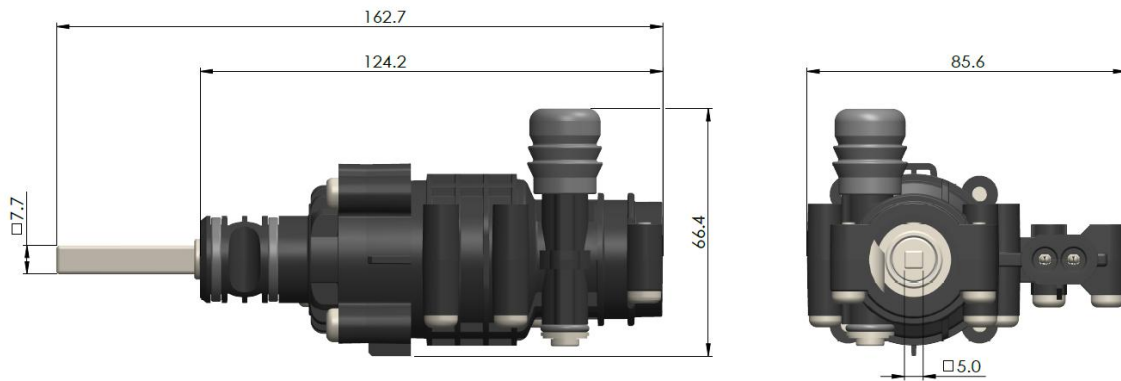

Note: All dimensions are in "mm"